

SURVEYOR'S RECORD

Section 34

Township 105

Range 40

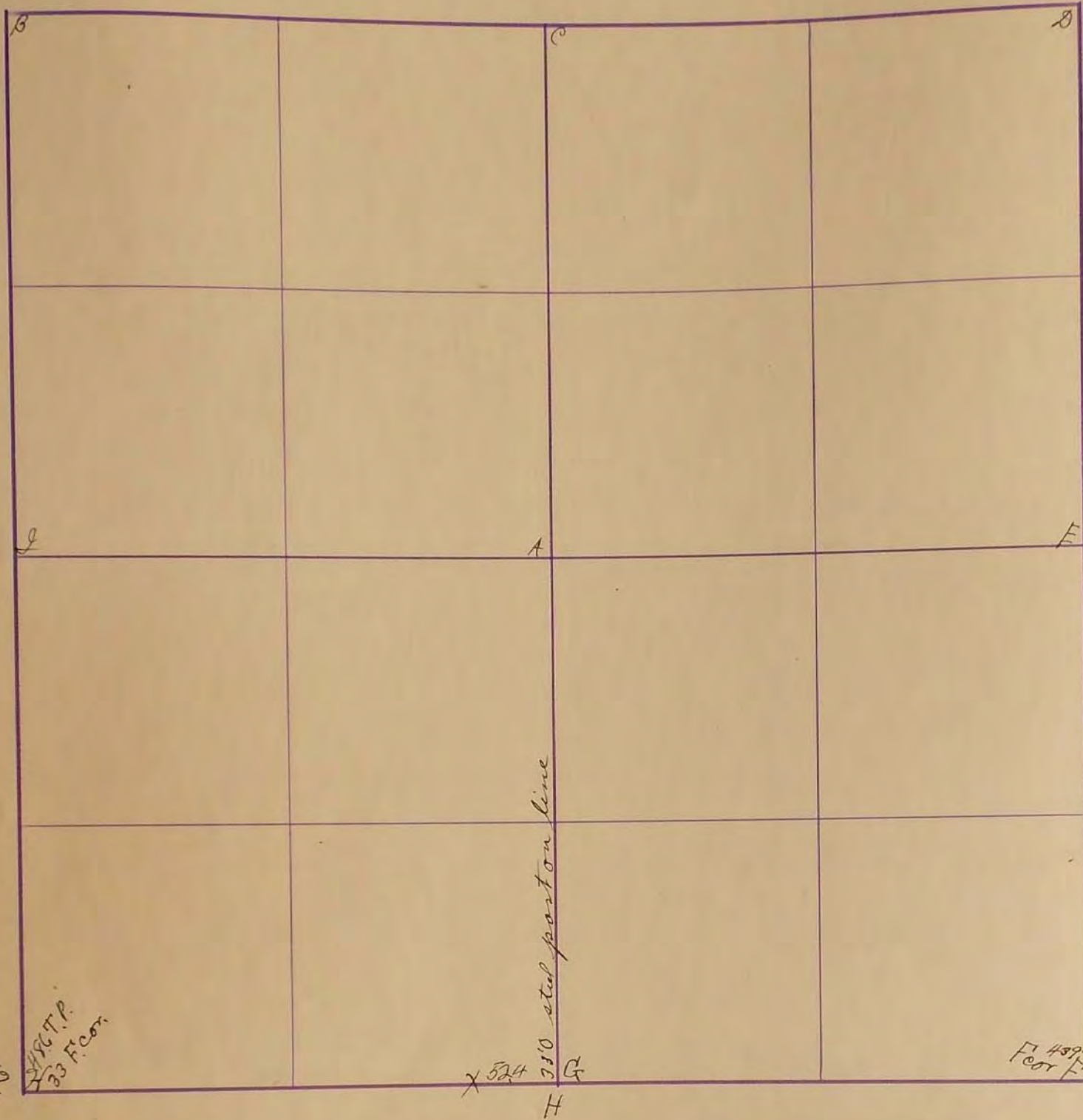

1934
 200 ft
 43'
 1/4 Sec. T.P.
 33 F. Cor.

X 524
 7 1/2' steel post on line
 G
 H

Fl 439
 F. Cor. 426 E. cor.

- 1934
- "B" "Found Stone": R.P. Tack in fence cor. SE. 43²; R.P. Edge of steel cor post SW. 47²; R.P. Tack in tel pole N.E. 50²
 - "C" "Found Stone": R.P. Tack in Cor fence post south 33²; R.P. Tack in Gate post N.W. 34¹
 - "D" "Found Stone": R.P. Tack in Blazed Cor fence post SW. 45²; R.P. Tack in Blazed fence post SE. 47² Also "B" sec 35-105-40 F.A. March

X Hobbs county corner 524 west of H

34
 35

SURVEY No. _____
 Section 34 Town 105 Range 40



FIELD NOTES.

"B" Found Stone R.P. Tack in fence cor SE 43.3'; R.P. Edge of
 Steel cor post SW 47.2'; R.P. Tack in tel pole NE 50.8'
 "C" Found Stone R.P. Tack in cor fence post south 33.2'; R.P. Tack in
 Gate post NW 34.2'
 "D" Found Stone R.P. Tack in Blazed cor fence post SW 45.8'; R.P.
 Tack in Blazed fence post SE 47.3'; Also "B" 35-105-40
 F.H. March 1934

X Noble County corner 52.4 west of G